

Warning on the use of LP Gas (LPG) cylinder adaptors

January 2024

Owners of barbecues and gas appliances are advised NOT to use adaptors to connect gas cylinders with old Type 21 (POL) valves to appliances with new Type 27 (LCC27) connections.

A homeowner recently received several burns resulting from fire from a gas cylinder in Western Australia. The injured person was hospitalised for further treatment.

It is known that an adaptor was used to connect a Type 27 (LCC27) connection to a Type 21 (Prest-O-Lite) (POL) valve.

LPG barbecue cylinders have also caused significant safety incidents in the past.

LPG cylinder valves and connections

A transition to safer LPG cylinder valves and LPG appliance connections has been made to improve consumer safety in South Australia and around Australia:

- Safer LCC27 cylinder valves were introduced on 1 April 2021 and mandated from 21 October 2021
- Safer LCC27 appliance connectors were introduced on 1 April 2022

All barbecues and gas appliances made after 1 April 2022 must be sold with the new connections specifically designed for the new LCC27 valve on gas cylinders.

LPG supply valve		Appliance connection (hose)
New Type 27 LCC27 LPG valve	can be connected to	New Type 27 LCC27 appliance
New Type 27 LCC27 LPG valve	can be connected to	POL appliance
Type 21 POL valve	can be connected to	POL appliance
Type 21 POL valve	cannot be connected to	New Type 27 LCC27 appliance

Why you should NOT use an adaptor

Adaptors that connect the new and safer LCC27 appliance connectors (hose fittings of barbecues and other LPG appliances made after 1 April 2022) with the old Type 21 (POL) gas cylinder valves can cause gas leaks.

The Type 21 (POL) LPG cylinder valve has a left-hand thread. The LCC27 appliance connection has a right-hand thread. This makes it extremely difficult to seal the two together – tightening the LCC27 appliance connections loosens the adaptor for the Type 21 (POL) cylinder valve.

These adaptors override the improved safety features of the new LCC27 valves.

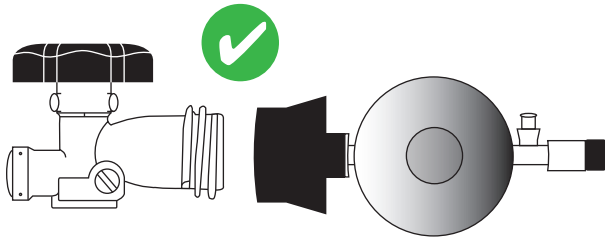

LCC27 valve + LCC27 regulator connection

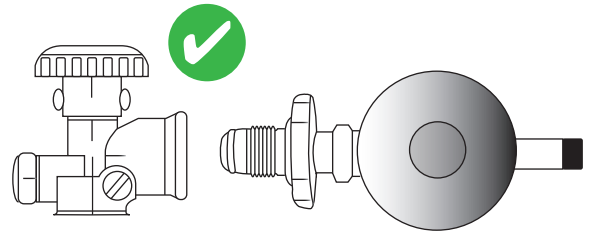

POL valve + POL regulator connection

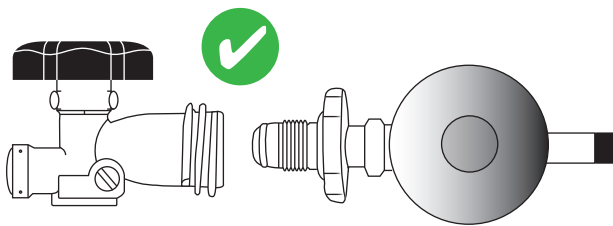

LCC27 valve + POL regulator connection

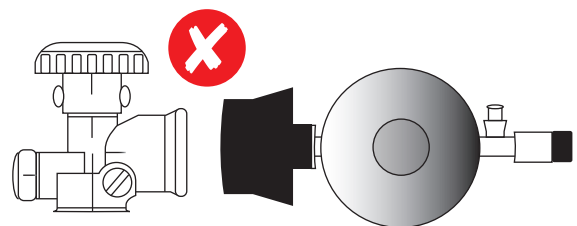

POL valve + LCC27 regulator connection

What you should do

Users of barbecues and gas appliances with the new LCC27 connections should:

- Stop using any gas appliance connected to adaptors on cylinders with Type 21 (POL) cylinder valves.
- Upgrade any old gas cylinder with a Type 21 (POL) valve to a gas cylinder with the newer LCC27 valve – DO NOT USE ADAPTORS.
- Make sure you know the correct procedures for connecting and operating gas cylinders.

Find out more about the LCC27 valve and connection:

Online: [SA.GOV.AU](https://sa.gov.au) - LPG cylinders and fittings

Email: otr@sa.gov.au

Phone: 1300 760 311



Government of
South Australia

Acknowledgement of Country

As guests on Aboriginal land, the Department for Energy and Mining (DEM) acknowledges everything this department does impacts on Aboriginal country, the sea, the sky, its people, and the spiritual and cultural connections which have existed since the first sunrise. Our responsibility is to share our collective knowledge, recognise a difficult history, respect the relationships made over time, and create a stronger future. We are ready to walk, learn and work together.